

Quick Reference Guide to the IBS 2026 App

The 2026 IBS mobile app is your guide to everything happening at the Builders' Show as well as the NAHB Board Meeting, committee and council meetings. You can communicate with other attendees, search education, events, meetings, speakers and exhibitors.

Finding the App

The app is available for download on *android and **iOS tablets and smartphones.

To find the 2026 NAHB International Builders' Show app, you can go to www.buildersshow.com/app from your device, click on the appropriate app store link and you will be taken directly into the store to download it. You can also search “**IBS 2026**” in your device's app store.

Upon download completion, you should see the IBS 2026 app icon.



NOTE for iOS users: If you have previously downloaded the IBS 2025 app, the IBS 2026 app will appear as an update.

NOTE for Android users: The app will not update in place, so if you have previously downloaded the IBS 2025 app, you will need to download the new 2026 version.

If the app icon looks different than what is shown above, then you have downloaded the wrong app. Please proceed back to the app store and re-enter “IBS 2026” in the app store search bar.

***Android users: Requires Android 12 & up**

****iOS users: Requires iOS 17.0 or later**

Logging in

Log in to get personalized content and to connect with attendees. Log in is not required to use the other features in the app. Logging in is only required to connect with other attendees and to play the app game. To log in, choose **My Profile** from the main navigation. You will be prompted to log in to the app.

Enter your registrant ID and your last name.

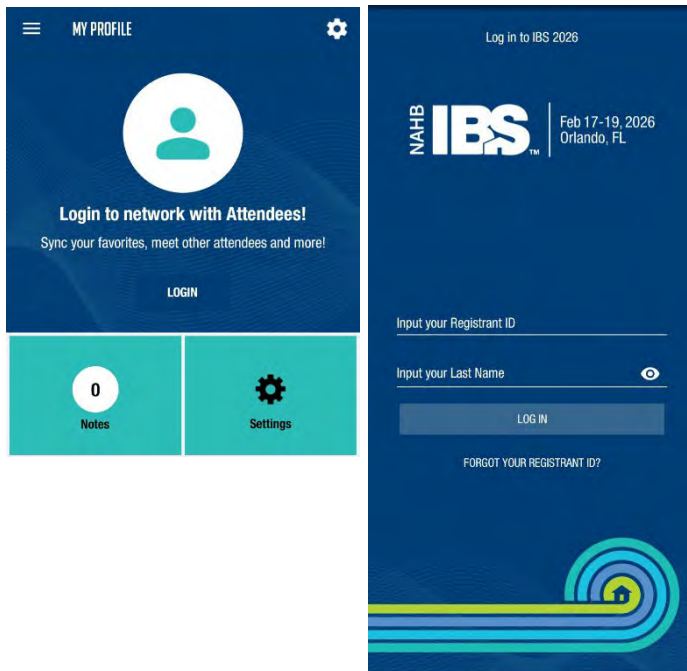

Log in to the app with your registrant ID and your last name. You can **find your registrant ID** on your registration confirmation email or on your badge.

NOTE: Your password is your last name and is case-sensitive, so it must be entered exactly as it appears in your registration confirmation email.



Confirmation

Thank you for registering for the 2026 NAHB International Builders' Show. Please save this email and confirmation ID number. To log back into your registration record to add new items or to make changes [click here](#).

Profile

Confirmation ID: 26148 1234
Lay Bragg

You should then see your name on the profile screen and in the navigation.

NOTE for iOS users: If you were previously logged into the 2025 app, please make sure you log out and then log back in with your 2026 credentials. If you are still unable to log in to the 2026 app, uninstall it and reinstall.

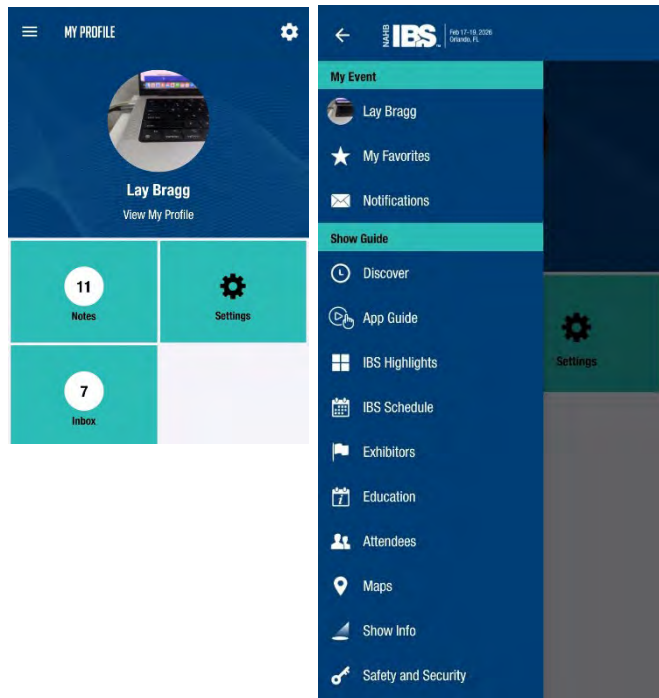

To connect with other attendees*, go to **My Profile** then **Settings** and opt in for attendee list and messaging. You must also opt-in to receive notifications. Under **Notifications and Alerts** right swipe the button to Opt-In for Notifications.

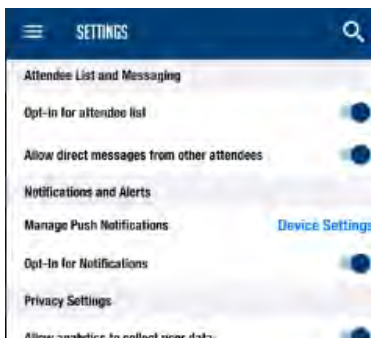

**Attendees can only connect with other attendees that have opted-in to receive messages. You must be logged in to use this feature.*

Getting Started

Access the main menu by tapping the upper left icon (the three lines). A menu will pop out on the left side.

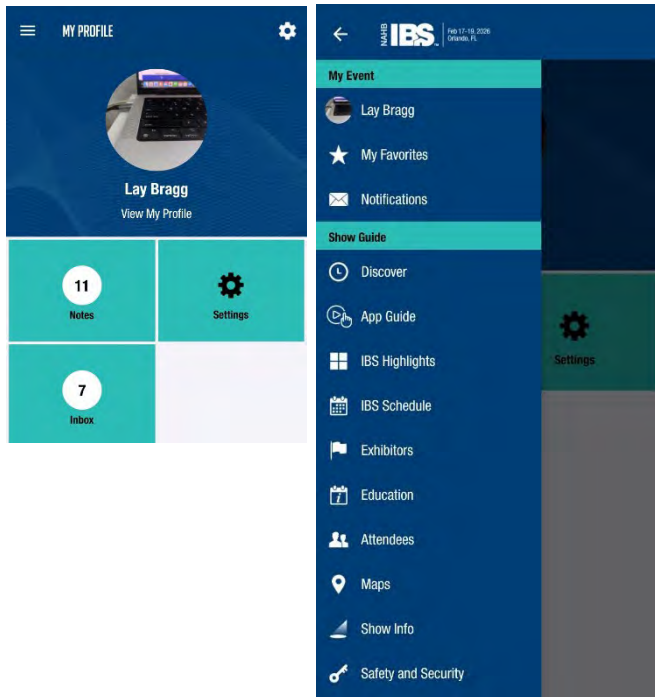

Main Information Screens

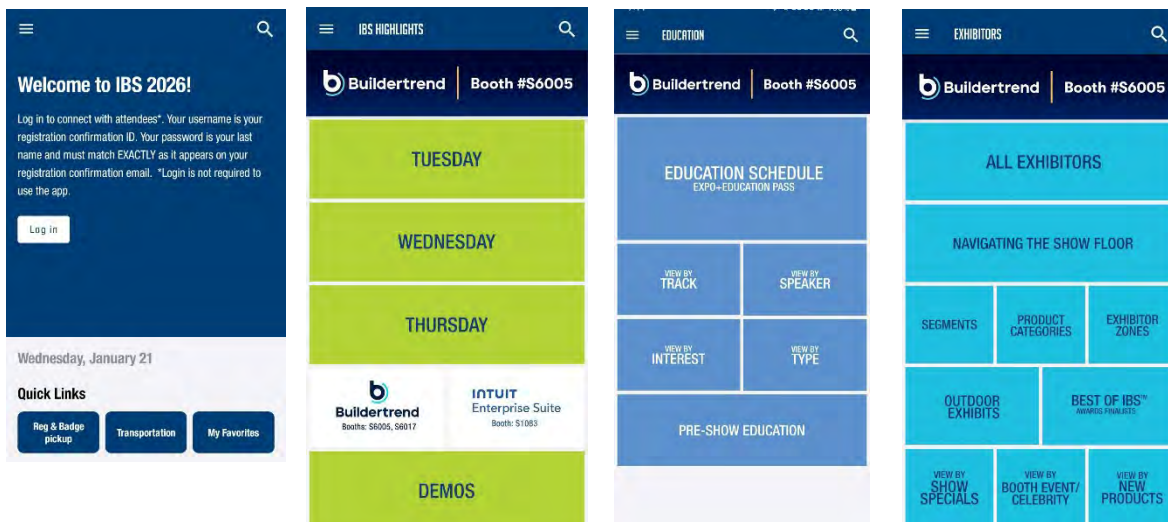

NEW! Attendee Checklists

The attendee checklist is a new feature in the Discover section of the app. Some activities in the checklist will only appear to users based on their reg type. Users will be able to either skip the activity or mark it as complete.

The checklist may include activities such as:

- Picking up your badge and/or event tickets
- Attending a special event
- Visiting NABH HQ for an NAHB members-only happy hour

IBS Schedule

Here you can see a day-by-day list of everything that is happening at the show – pre-show courses, meetings, education sessions and events.

If you'd like to add a meeting or event to your agenda, tap the **Add to Agenda** button on the left next to the meeting/event. You can also do this inside the meeting details page.

Once you have tapped the button, it will appear under **My Agenda**. Tapping into an event will open the event details page. Here you can see the event location, description, speakers, date and time.

Schedule:

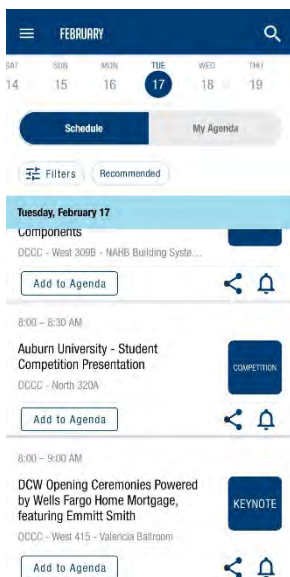

My Agenda:

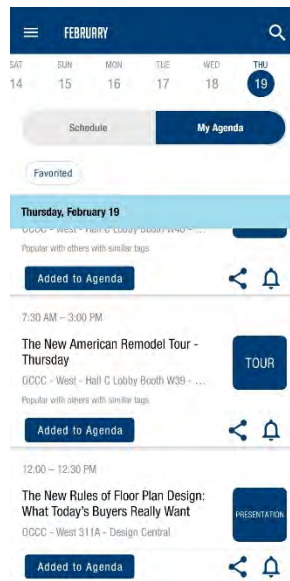

Event Details:

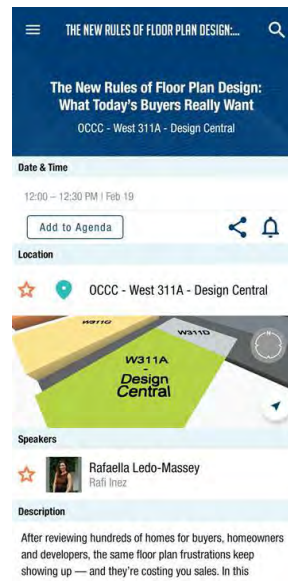

Finding Events, Education & Meetings

To browse the full IBS Schedule of events, education and meetings, tap the main menu icon (the three little lines) in the upper left corner. This will cause the main menu to pop out again.

1. Choose **IBS Schedule**. Choose an individual day. By default, the schedule will show **All**, but you can apply a filter to see just NAHB meetings, IBS Education sessions or events.
2. To view the list of filters, tap the filter icon in the upper right corner. You can use the slider to select the time of day.
3. View your filtered list.

Step 1:



Step 2:

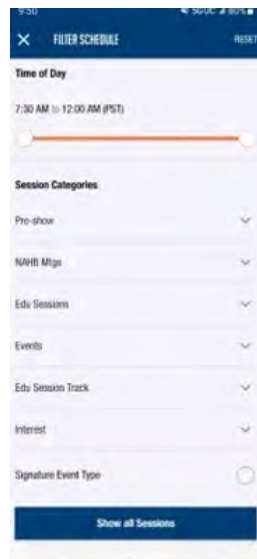

Step 3:

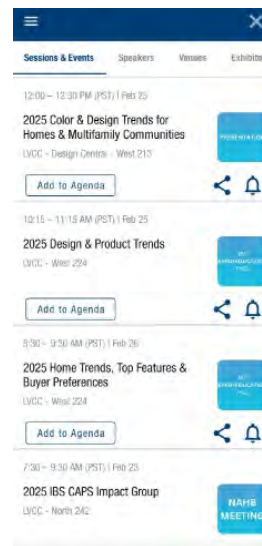

Finding Committee Meetings

To browse the committee meetings, tap the main menu icon (the three little lines) in the upper left corner. This will cause the main menu to pop out again.

1. Scroll down to **NAHB Mtgs & Info**.
2. Choose **Committee Meetings**.
3. Scroll down and browse the list, or search for a specific meeting.

Finding Exhibitors

To browse IBS Exhibitors, tap the main menu icon and choose **Exhibitors**. On the Exhibitors screen, you can choose **All Exhibitors**. You can also browse by **Segments**, **Product Categories** and more.

Exhibitors:



Segments:



Segmentation

The IBS exhibit halls will be divided into six categories, making it easier for you to navigate the exhibit floor, save time and find the products and services you're looking for at the show.

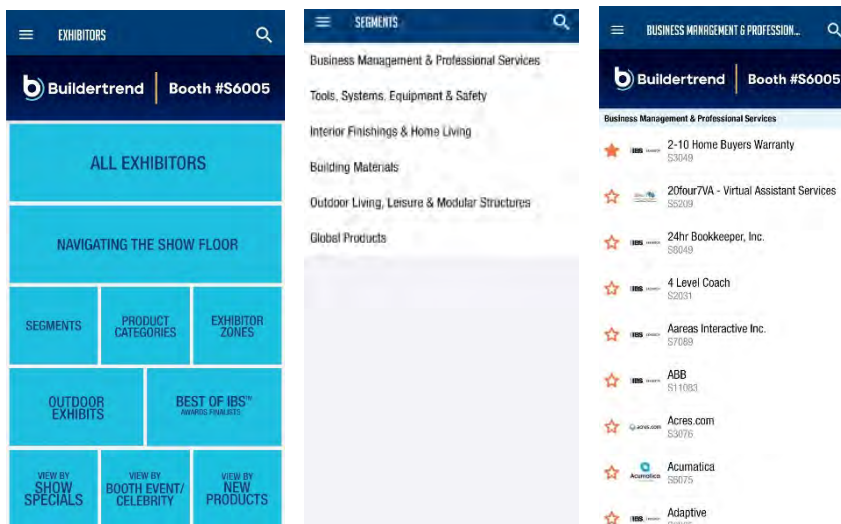

Navigating the Show Floor

Spanning 700,000+ square feet, this year's show features more than 1,700 exhibitors from all over the world. The best way to navigate the show floor is the interactive map. The map is color coded by the IBS segmented layout with exhibitors grouped together by product and service categories.

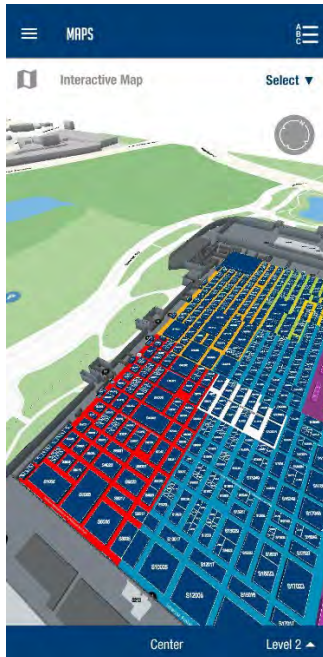

You can route between locations by searching for the meeting, event, or exhibitor and tapping the navigation button. Tap **tap to edit** to bring up a list of locations and select your starting point or tap **Filter** in the upper left of the screen to enter the name or room/booth number. Once you select the location in the lower left you will see how long it will take to get to the destination. Tap **Navigate** and follow the routing instructions. See example below - routing to Design Central, located in room West 311A.

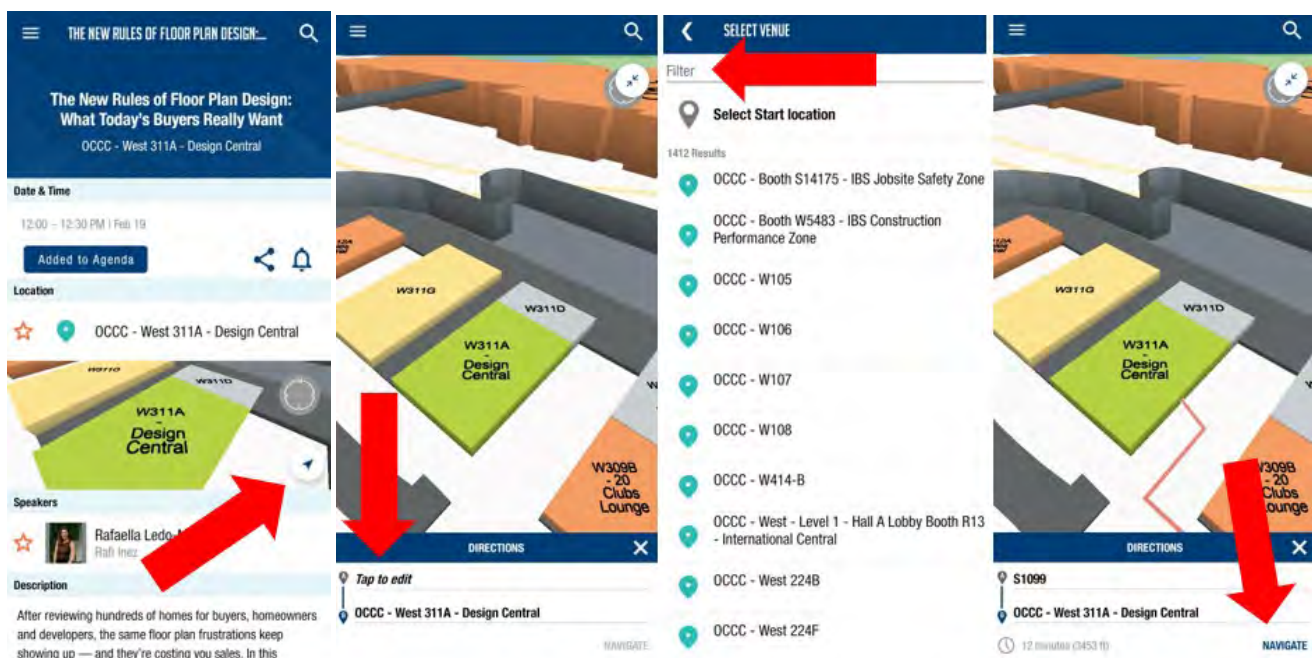

Routing:

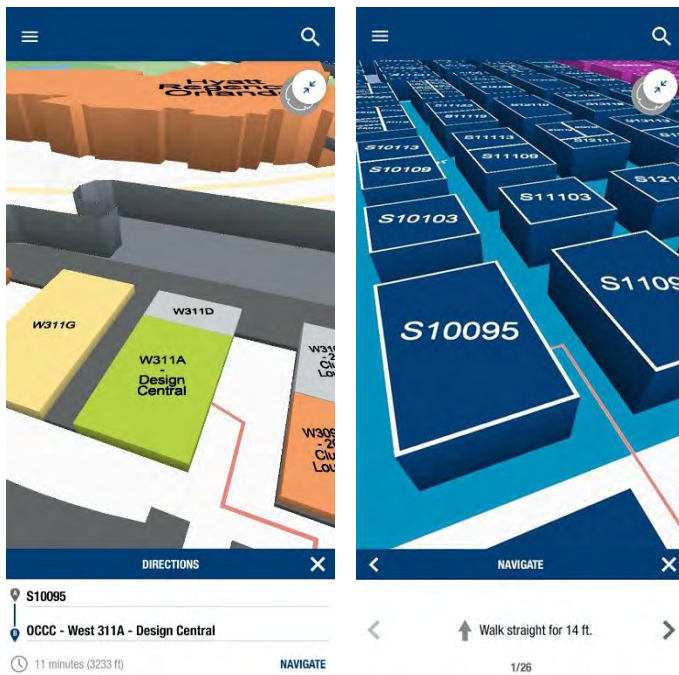

Other ways to Find Items in the App

Under the main navigation menu:

1. You can find a daily “What’s happening” and info on marquee events under **IBS Highlights**.
2. You can browse IBS Education sessions under **Education** and view them by several different filters. You’ll also find information about pre-show courses here and IBS Speakers.
3. You can find out what’s going on in the different IBS Centrals and other communities under **Communities & Centrals**.
4. You can find NAHB committee meetings and board meeting information under **NAHB Mtgs & Info**.

If you are looking for something specific, **use the search bar** to find meetings, events, education, speakers or exhibitors by name. Tap the **Search Icon** (the magnifying glass) in the upper right corner from anywhere in the app and type in all or part of the name to find your meeting, then review the search results and select the meeting:

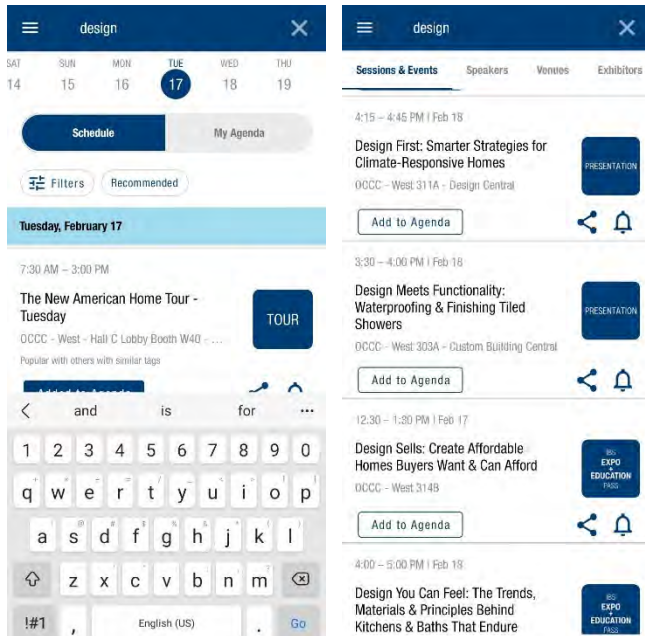

Adding to Your Favorites & Agenda

As previously mentioned in the IBS Schedule section, to add a meeting, event or session to your agenda, tap the **Add to Agenda** button. It will appear under **My Agenda** under **IBS Schedule**.

To add a speaker or exhibitor to your favorites, click the star next to the speaker or exhibitor. Once you have favorited a speaker or exhibitor it will appear under **My Favorites** (located on the main menu).

All Exhibitors:



Exhibitor details:

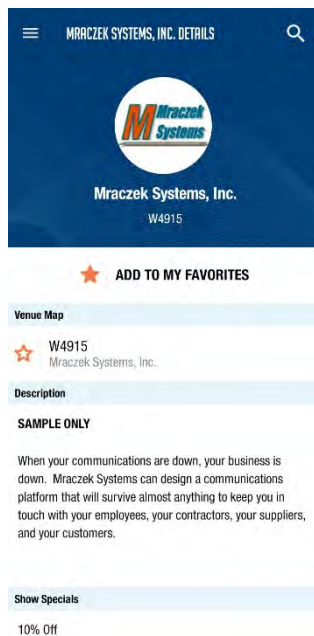

My Favorites Page:



Add a Meeting or Event Reminder

When you are viewing a list, or an individual meeting or event, you can also add a reminder by clicking on the bell icon on the right side of the meeting/event title. This will schedule a notification reminder five minutes before the meeting or event begins.

No reminder:

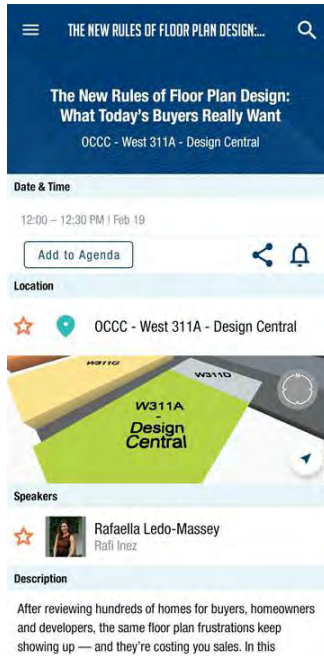

Reminder set:

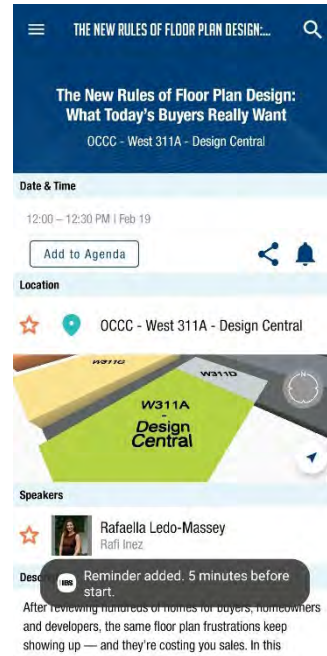

Safety & Security

In the Safety & Security section of the app, you'll find show security information and emergency phone numbers, as well as a link to text show security. You can also send a text as an opt-in to receive emergency alerts during the show.



ANDROID USERS: Your device must have a data plan to use the security and emergency alerts text feature in the Safety & Security section of the app.

And those are the basics to get you around IBS! If you have any questions about using the app, please contact Jennifer Sloane at jsloane@nahb.org, or Lay Bragg at lbragg@nahb.org. You can also reach out to us on social media with #IBS2026. Enjoy the show!